

TECHNICAL DATASHEET SANITARY SYSTEMS / FLUSH PLATE

CRESCENT DUAL FLUSH – STAINLESS STEEL

(including concealed security screws)

TRF0433C



CRESCENT DUAL FLUSH – WHITE

TRF0400C



CRESCENT DUAL FLUSH – CHROME

TRF0427C

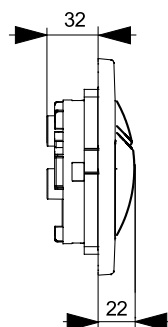
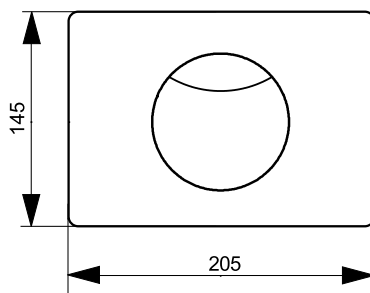

- Dual flush push plate
- Material: ABS Plastic
- Surface mounted
- Cable operated

WC FRAME AND CISTERN OPTIONS

WC FRAMES

TRM1820 – 820MM

TRM1985 – 985MM

TRM1200 – 1185MM

TRM1201 – 1185MM

(SPECIAL NEEDS)



CISTERN

TRV1820 – CONCEALED DUAL
FLUSH CISTERN



Sales hotline
01622 852 654

Support hotline
01622 852 798

Email
info@multikwik.com

WWW.MULTIKWIK.COM

Twitter @multikwik

TRUST MULTIKWIK

